



# Event Rentals

MUSEUM **MIT**

**Host your next event at the re-imagined MIT Museum.** Now located in MIT's Kendall Gateway, the museum's 56,000 square feet of purposely designed space offers the perfect setting for events of all types and sizes. Rent the entire museum or just a portion of it.



# Ground Floor

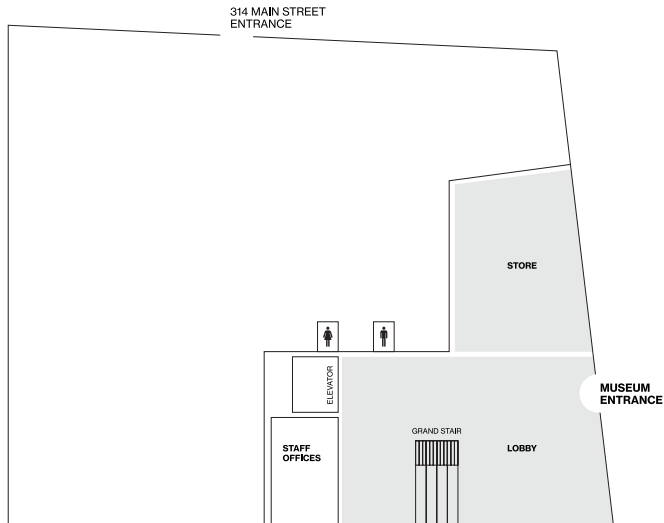

## Lobby

The museum's ground floor atrium-style lobby, featuring inspired architectural detail and art installations is a perfect event destination. Its open floor plan and grand staircase features stadium seating that can accommodate guests for receptions, or serve as a check-in area for larger events.

<b>Capacity</b>	<b>125</b>	<b>Reception</b>
	<b>80</b>	<b>Theater</b>

# Second Floor

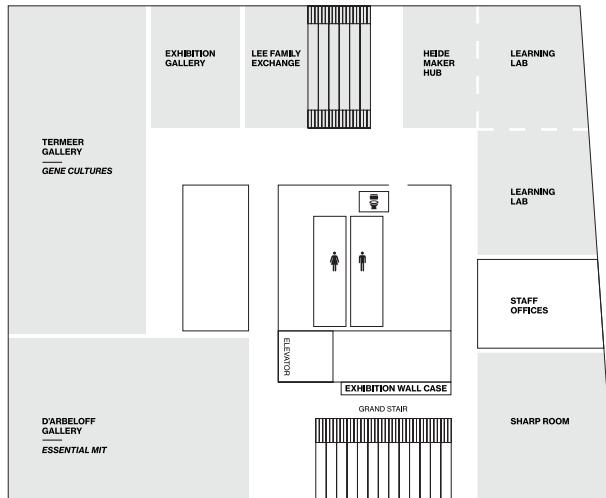

## Phillip A. Sharp Room

Our second-floor function room, with views of MIT's vibrant Open Space, is available during both daytime and evening hours. Whether hosting a business meeting or social gathering, the room is flexible, allowing you to tailor it to your specific needs. Use of state-of-the-art audio-visual equipment is included.

<b>Capacity</b>	<b>80</b>	<b>Theater-Style Conference</b>
	<b>80</b>	<b>Seated Dinner</b>
	<b>80</b>	<b>Reception</b>

## Brit J. (1961) and Alex (1949) d'Arbeloff Gallery

Host a reception or seated dinner among the artifacts celebrating MIT's past and ongoing innovations in our *Essential MIT* exhibition gallery. This open space rents as a unit with our other second floor galleries, providing a dynamic area for guests to explore.

<b>Capacity</b>	<b>70</b>	<b>Seated Dinner</b>
	<b>250</b>	<b>Reception</b>



# Third Floor

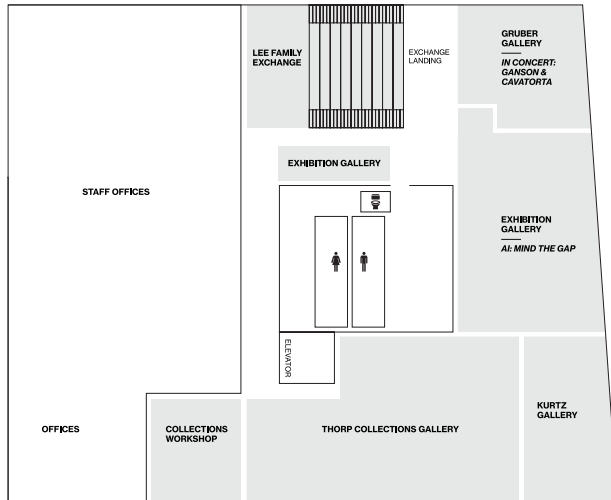

## Yuchun (1989) and Agustina Lee Family Exchange

Our dramatic *Exchange* forum space, with soaring ceilings, massive digital screen and built-in stadium seating spanning two floors provides a unique setting for events that include presentations, movie screenings, and performances.

<b>Capacity</b>	<b>100</b>	<b>Theater</b>
-----------------	------------	----------------

## Galleries

The third-floor galleries, including exhibitions on artificial intelligence, kinetic sculpture, and a large dedicated space for objects from our vast collection are available with a full-museum buyout.

<b>Capacity</b>	<b>700</b>	<b>Reception</b>
<b>Full Museum including third-floor galleries</b>		

# Preferred Caterers

Our Preferred Caterers have been selected for their excellent cuisine, attractive presentations, and attention to detail. The Museum works exclusively with these vendors:



## **Capers Catering**

Chuck Ray  
781-279-5100  
cray@caperscatering.com  
caperscatering.com

## **Gourmet Caterers**

John McGinn  
857-728-2093  
johnmc@gourmetcaterers.com  
gourmetcaterers.com

## **Cuisine Chez Vous**

Fiona Casey  
617-576-3652  
info@cuisinechezvous.com  
cuisinechezvous.com

## **Johnny Burke Catering**

Danielle Collin  
617-312-1408 x101  
danielle@johnnyburkecatering.com  
johnnyburkecatering.com

## **East Meets West**

Brooke Bowden  
617-269-2662 x114  
bbowden@emwcatering.com  
eastmeetswestcatering.com

## **Jules Catering**

Paula Welte  
617-628-5977  
pwelte@julescatering.com  
julescatering.com

## **Forklift**

Kristen Campbell  
617-776-7600  
kristen@forkliftcatering.com  
forkliftcatering.com

## **Rita's Catering**

Kristin Petrarca-Allyn  
617-389-1601  
mitmuseum@ritascatering.com  
ritascatering.com

# Rates and availability

Through June 30, 2024



---

<b>Lobby</b>	<b>\$3,000</b>
--------------	----------------

---

<b>Second Floor Galleries</b>	<b>\$5,000</b>
-------------------------------	----------------

*Essential MIT, Gene Cultures, Tracing Threads*

---

<b>Second Floor Sharp Room</b>	<b>\$500/hour</b>
--------------------------------	-------------------

(4-hour minimum)

---

<b>Lee Family Exchange</b>	(without AV) <b>\$2,000</b>
	(with AV) <b>\$4,000</b>

---

<b>Entire museum rental</b>	<b>\$12,000</b>
-----------------------------	-----------------

---

<b>Extended Store hours</b>	<b>\$250/hour</b>
-----------------------------	-------------------

(based on availability)

---

*Additional fees may apply for events on weekends or holidays, with expected guest counts over 400, or for other specific circumstances or services. The Event Rentals Manager can provide an estimate of any additional fees prior to reservation.*

*With the exception of the Sharp Room, rentals are available from 5:00–11:00pm daily. The Sharp Room can be reserved from 7:00am–11:00pm.*

For more information, email  
**[museumevents@mit.edu](mailto:museumevents@mit.edu)**.